

LOCATION MAP
NOT TO SCALE

LEGEND

- ALUMINUM COVERED WALKWAY SYSTEM
- COVERED ENTRY W/ CLAY TILE ROOF SYSTEM

TABULAR DATA

NAME OF PROJECT		PALM BEACH PUBLIC ELEMENTARY SCHOOL	
PROPOSED USE(S)		PUBLIC EDUCATIONAL FACILITY	
TOTAL STUDENT POPULATION		446	
FUTURE LAND USE DESIGNATION		.	
EXISTING ZONING DISTRICT		.	
SECTION/TOWNSHIP/RANGE		22/43/43	
PROPERTY CONTROL NUMBER		.	
TRAFFIC ANALYSIS ZONE (TAZ)		.	
TOTAL GROSS SITE AREA	2.424 AC /	105,806 SF	
TOTAL GROSS BUILDING FLOOR AREA	.		
PROPOSED BUILDINGS			
1ST FLOOR	49,752 SF	.	
2ND FLOOR	19,777 SF	.	
TOTAL EXISTING AND PROPOSED	69,529 SF	.	
FLOOR AREA RATIO (FAR)	69.5	.	
BUILDING COVERAGE (%)	40.77 %	.	
IMPERVIOUS SURFACE AREA (AC & %)	1.64 AC / 68 %	.	
RETENTION AREA (AC & %)	NOT APPLICABLE	.	
DETENTION MAXIMUM DEPTH FROM FINISHED GRADE	N.A.	.	
PERVIOUS OPEN SPACE (AC & %)	0.78 AC / 32 %	.	
BUILDING HEIGHT	30'-8"	.	
NUMBER OF STORIES/FLOORS	TWO	.	
F.E.M.A. FLOOD ZONE	A7	.	
F.E.M.A. FLOOD PLAN ELEVATION (NGVD)	+7.00 FT	.	
PROPOSED FINISHED FLOOR ELEVATION (NGVD)	+8.00 FT	.	
AVERAGE FINISHED GRADE ELEVATION (NGVD)	+7.00 FT	.	
CHANGE FROM CURRENT GRADE	+2'-0" ±	.	
PARKING TABULATION			
STAFF	14	14	14
SERVICE PERSONNEL	5	5	5
VISITORS	0	0	0
TOTAL	19	19	19
HANDICAPPED PARKING (INCLUDED IN ABOVE TOTAL)	1	2	2

OVERALL SITE PLAN 01
SCALE: 1"=30'-0"

宋
Song + Associates
Architect • Planning • Interior Design
400 Australian Ave S. 8th Floor
West Palm Beach, FL 33411
Telephone: 561-853-2423
Fax: 561-853-1482
A.A. - 0003165 I.B. - 0001095
Spcl :

Consultants :

The School District
of
Palm Beach County



PALM BEACH
PUBLIC
SCHOOL

SDPBC PROJ NO. 0421-8221

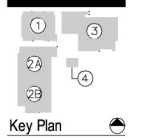

Key Plan

Date: 03/31/04
S+A Proj. No. 01149
Owner Proj. No. 0421-8221
Drawn By: CD/RH
Checked By: TK

- 7-7-04 ASI 1
- 12-21-04 ASI B

Sheet Title:

OVERALL SITE PLAN

Sheet # :

A0.1.0
CONSTRUCTION DOCUMENTS
PHASE III SUBMITTAL